



GL1

Gun Rail Light User Manual

Thank you for choosing Klarus products!
Please read the user manual fully before use.

(EN) English

Specifications

- Model: GL1
- Main LED: CREE XP-L2 HD
- Dimensions: 56mm(2.20") x 28mm(1.10") x 31.6mm(1.24")
- Compatible: MIL-STD-1913, Glock or Weaver rails
- Switch: Twin switch
- Battery Capacity: 260mAh
- Waterproof: IPX 6
- Weight: 60.5g(2.13oz)

Package

Name	Qty	Name	Qty
Gun Rail Light	1	Screws	2
Charging Cable	1	Screwdriver	1
1913 Picatinny rail adapter	1	User Manual	1

ANSI

Specification	Mode	Constant On	Strobe
ANSI lumens(LM)		600	600
Runtime(h)		1	0.5
Beam intensity(cd)		1722	
Beam distance(m)		83	
Impact resistance(m)		1	
Waterproof			IPX6

Note:

- Each time the light is turned ON, the lamp will be in max output for 1 minute. The output will be progressively reduced to 70 lumens within 10 minutes.
- Data are based on Klarus lab tests. Actual results may differ based on usage and conditions.

Operations

ON/OFF:

ON/OFF: Press the left or right switch to turn ON, press again to turn OFF.
Momentary: click and hold the switch for momentary ON, release to turn OFF.
Strobe: double click any switch to enter Strobe, single click to turn OFF.

Mount Installation

Glock and Weaver Rail Compatible:

Loosen the clamp → place the clamp onto the rail → slide to the appropriate location and tighten the clamp

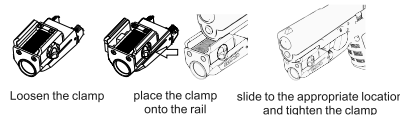

MIL-STD-1913 Picatinny Rail

Attach the 1913 Picatinny rail adapter → Loosen the clamp → place the clamp onto the rail → slide to the appropriate location and tighten the clamp

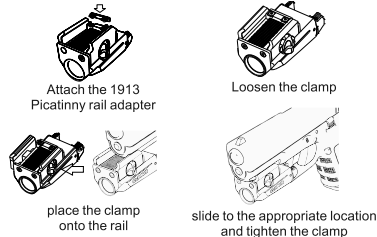

※Ensure the light is securely attached to the firearm before using.

Battery Capacity Indicator

- After power-on, the indicator will turn on for 5 seconds to indicate the battery capacity and turn off after 5 seconds.
- Green, 70%-100%
- Orange, 30%-70%
- Red, less than 30%

How to Charge

GL1 battery can be charged directly from the included USB cable by plugging it into any USB outlet.

Recharging Indicator

- 1)Red: charging in progress
 - 2)Green: charging complete
- ※Please keep the battery charged to full for storage.

Note:

- The included battery is charged to approximately 50% by default and will not support maximum output and standard runtime. Please charge the battery fully before first use.
- Do not shine directly into eyes to avoid damage.
- The lamp will run in max output for 1 minute, and progressively reduce output to 70 lumens within 10 minutes.
- After fired each 500 rounds, please check whether the light is loosen, and tighten the screw again

Warranty

- KLARUS guarantees the light against defects in material and workmanship. The products that are found to be defective under normal use within 2 years of the purchase date will be repaired or replaced without charge.
- Do not disassemble or modify this product which can cause damage and will void the warranty.
- Please keep your receipt and proof of purchase for warranty.

Limited Lifetime Warranty

- If problems develop after 2 years from the date of purchase, KLARUS will charge for parts and repairs. The total repair fee will be assessed according to the cost of the replacement materials. If damage to the light is substantial, KLARUS will contact the customer via the dealer with a quote.

Warranty Procedure

- If this light does not perform as specified, the product will be repaired or replaced as described above.
- Please contact your original KLARUS dealer for replacement and repairs.
- If the warranty issue cannot be resolved by the dealer, please contact KLARUS at service@klaruslight.com for assistance. Please provide the following information to expedite the process:
 - 1) List the serial number on the light.

- 2) Include a detailed description identifying the issue, accompanied by pictures or a short video demonstration if necessary.
- 3) Provide the name and store of the dealer you made the purchase from; and a copy of the proof of purchase.

Note

- Product specifications of this printing is accurate, any updates will be reflected in the physical product. There may be slight difference between photographic and actual product.
- KLARUS reserve the right to make the final determination of terms and conditions in this manual.
- Scan the QR code and receive the latest update from KLARUS media account or KLARUS official website.



Website



Facebook

KLARUS LIGHTING TECHNOLOGY CO., LIMITED

Address: 8/F, E Building, Longjing Industrial Science Park, 335 Bulong Rd, Bantian St. in Longgang District, Shenzhen, China, 518000.
Phone: +86-755-27700110
Email: service@klaruslight.com
Website: www.klaruslight.com



Made in China



GL1

枪灯使用说明书

感谢阁下惠顾本公司产品使用前敬请详细阅读说明书

(CHS)中文

产品参数

- 产品型号: GL1
- 主灯 LED: CREE XP-L2 HD
- 尺寸: 56mm*28mm*31.6mm
- 支持导轨: MIL-STD-1913、GLOCK和Weaver式手枪导轨
- 开关类型: 双按压开关
- 电池容量: 260mAh
- 防水等级: IPX 6
- 重量: 60.5g
- 质保: 2年

装箱清单

部件名称	数量	部件名称	数量
枪灯	1	螺丝	2
充电线	1	螺丝刀	1
1913导轨适配器	1	说明书	1

ANSI标准参数

项目	模式	常亮	爆闪
光通量(LM)		600	600
续航时间(h)		1	0.5
光强度(cd)		1722	
射程(m)		83	
防跌落(m)		1	
防水级别			IPX6

注:

- 1.枪灯每次开启,都在最高亮度输出模式下工作一分钟,然后10分钟内缓慢降低到70流明。
- 2.以上数据来源于凯瑞兹实验室,如有偏差,请以实物为准

产品使用方法

1、开启/关闭

开/关: 按压左/右按键开启灯光,再次按压关闭灯光;
瞬亮: 长按左/右按键点亮灯光,松开炮灭;
爆闪: 快速双击左/右按键进入爆闪,再次单击关闭灯光;

如何安装

1.Glock和Weaver式导轨枪支安装

拧松导轨夹旋钮一按压旋钮,将手枪灯夹持于手枪导轨上一滑动到合适位置,拧紧旋钮;



2.MIL-STD-1913导轨枪支安装

安装1913导轨适配器一拧松导轨夹旋钮一按压旋钮,将手枪灯夹持于手枪导轨上一滑动到合适位置,拧紧旋钮;

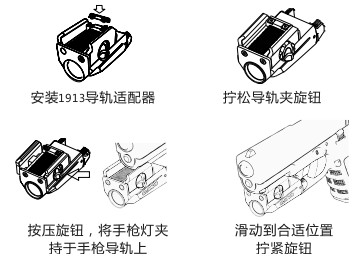

※使用时,请确保枪灯牢固的固定在枪支上,以防止损坏或出现其它意外。

电量指示

灯头指示灯在开机后点亮5秒指示电池电量,5秒后关闭。

- 绿色: 70%-100%
- 橙色: 30%-70%
- 红色: 30%以下
- 红灯闪烁: 10%以下

如何充电

GL1电池采用USB直充设计,可通过USB数据线、座充、车充等设备直接进行充电。

充电提示

- 1) 指示灯显示红色: 充电进行中
 - 2) 指示灯显示绿色: 充电完毕
- ※长时间存放枪灯时,请先将电池充满电。

注意事项

- 1.充电电池出厂时只有50%以下电量,直接使用不能达到最高亮度和正常续航时间,首次使用请将电池充满;
- 2.请勿将枪灯的光线直接照射人类或动物的眼睛,以免对眼睛造成伤害;
- 3.枪灯在最高亮度输出模式下将工作一分钟,然后10分钟内缓慢降低到70流明。
- 4.建议每射击500发子弹后,检查枪灯是否松动,并重新拧紧固定。

售后/保修条款

- 1.15天保换: 凯瑞兹产品自售出日起15天内,在正常使用情况下,若出现质量问题,可免费更换同型号产品。若该产品已停止生产,则调换该型号升级品或不低于原产品性能的其他产品。
- 2.2年质保: 凯瑞兹产品自售出日起2年内,在正常使用情况下,若出现质量问题,享受免费维修服务。
- 3.终身有限保修: 因不当使用引起的产品损坏或超出免费保修时间的产品,我司将提供有偿保修,费用以实际更换材料费用为准,不另收取人工费。
- 4.用户务必妥善保存好产品的《有效购买凭证》,以备保修或维修时使用。

※产品升级、规格参数如有更新,恕不另行通知,实际产品的形式和颜色则可能与实物所显示略有不同,请以实物为准。深圳市凯瑞兹电子科技有限公司拥有对说明书内容的最终解释权 and 修改权。



微信公众号

深圳市凯瑞兹电子科技有限公司

地址: 深圳市龙岗区坂田街道龙景科技园E栋8楼
邮编: 518000 电话: 400-631-0169
邮箱: service@klaruslight.com
网站: www.klaruslight.cn



Made in China